

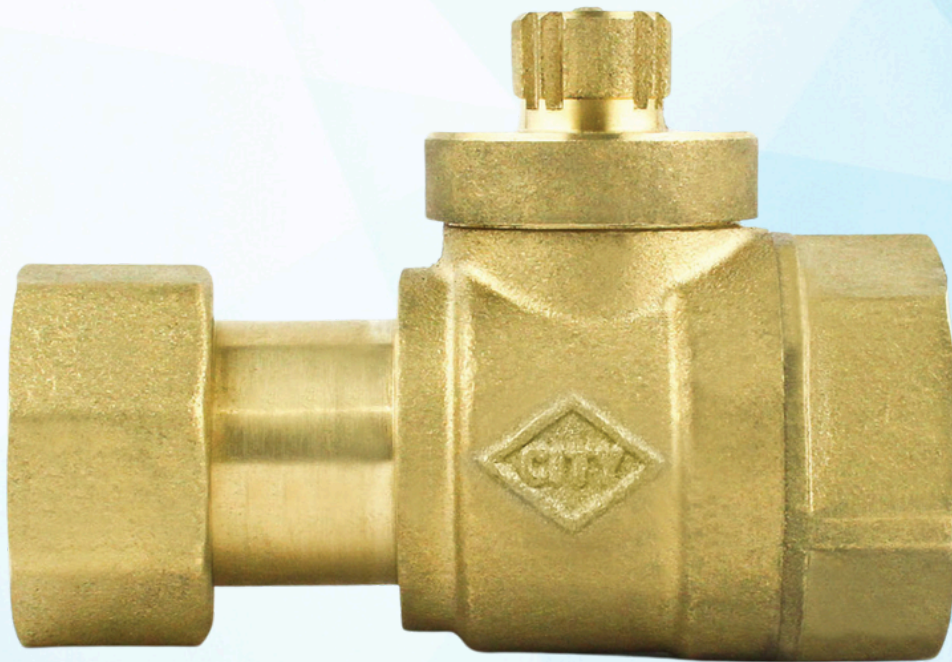

FORGING BRASS LOCKABLE BALL VALVE (S)



Reliable · Durable · Affordable

FORGING BRASS LOCKABLE BALL VALVE (S)

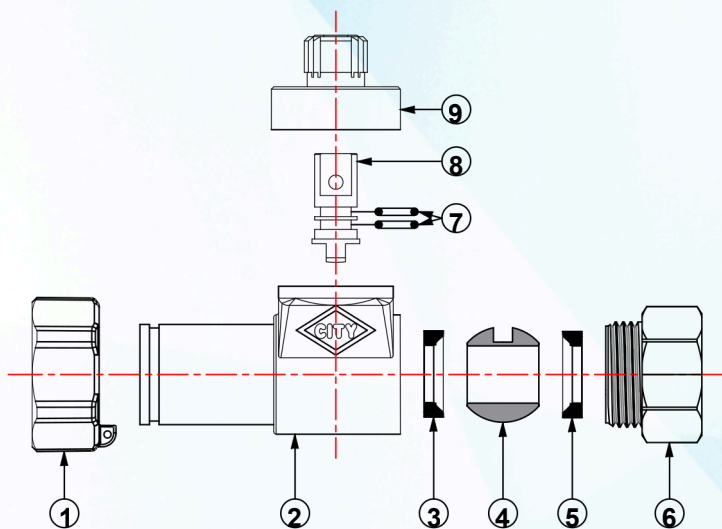

Part	Part Name	Material
1	Coupling	Forged Brass
2	Body	Forged Brass
3	Teflon Seat	Teflon
4	Ball	Stainless Steel
5	Teflon Seat	Teflon
6	Attachment	Forged Brass
7	Stem O-Ring	Nitrile Rubber
8	Stem	Brass Rod
9	Handle Cap	Forged Brass

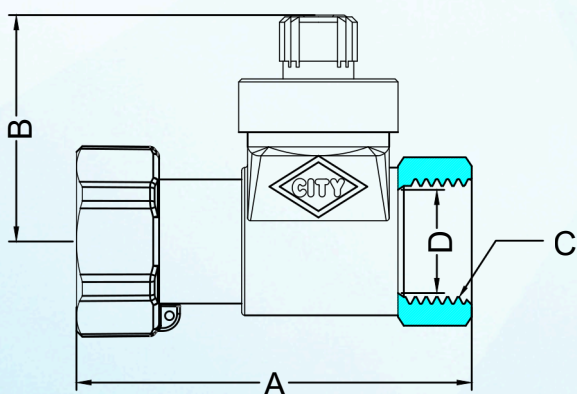

Art No	Size	A	B	C	D
1401	1/2"	67.0	38.0	BSPP 1/2"	12.0

Nominal Pressure: 16 bar
Working Temperature: < 90°C



WELL-BUILT ALLOY INDUSTRIES SDN BHD

No 5, Jalan Riang 24, Taman Gembira, 81200 Johor Bahru, Johor, Malaysia.

Tel: +607-3329173 Fax: +607-3328664 Email: info@wellbuiltalloy.com.my

Website: www.wellbuiltalloy.com.my